

# FRONT STUBBY BUMPER

SKU# FBM21JPN-RT

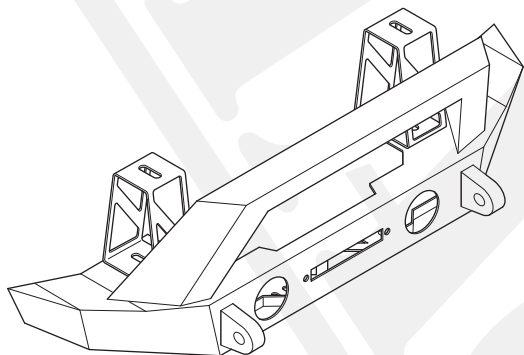

## Bumper Components:



Heavy Duty Bumper  
Qty 1

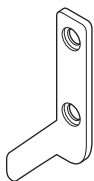

Outside Nut Plates  
(1 driver/1 pass)  
Qty 2

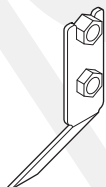

Inside Nut Plates  
(1 driver/1 pass)  
Qty 2

## Bumper Hardware:

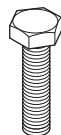

7/16"-14 x 1-1/2" Grade 8  
Hex Head Bolts  
Qty 80



7/16" Grade 8  
Flat Washers  
Qty 14



7/16" Grade 8  
Lock Washers  
Qty 8



7/16"-14 Grade 8  
Hex Head Nuts  
Qty 4

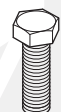

3/8"-16 x 1.25" Grade 8  
Hex Head Bolts  
Qty 2



3/8" Grade 8  
Flat Washers  
Qty 2



3/8" Grade 8  
Lock Washers  
Qty 2

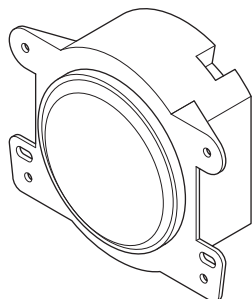
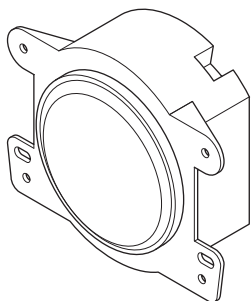

## O.E. Fog Light Hardware:



10-24 x .750"  
Button Head Bolts  
Qty 9



10-24  
Flat Washers  
Qty 8



Serrated Flanged  
Nuts or Keps Nuts  
Qty 8

**Skid Plate Hardware:**

Skid Nut Plates  
(1 driver/1 pass)  
Qty 2

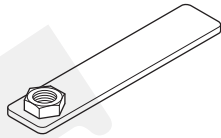

**Skid Plate Hardware:**



3/8-16 x .750"  
Button Head  
Bolts SS  
Qty 4

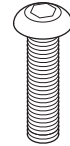

7/16-14 x 1.50"  
Button Head  
Bolts SS  
Qty 4



3/8"  
Flat Washers SS  
Qty 4



7/16"  
Flat Washer SS  
Qty 4



3/8"  
Lock Washers SS  
Qty 4



7/16"  
Lock Washer SS  
Qty 4

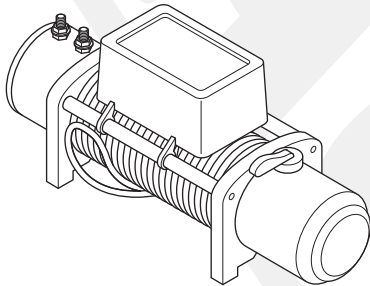

**Winch Mount Hardware:**

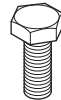

7/16-14 x 1" Grade 8  
Hex Head Bolts  
Qty 4



7/16" Grade 8  
Flat Washers  
Qty 4



7/16"  
Lock Washer  
Qty 4

**Jack Mount Hardware:**

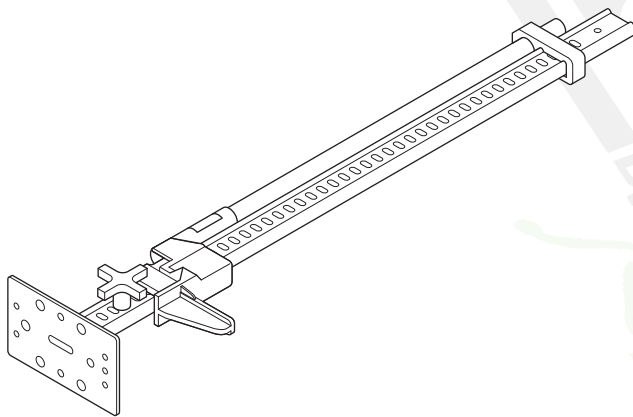

**Jack Mount Hardware:**

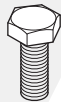

7/16-14 x 1" Grade 8  
Hex Head Bolts  
Qty 4



7/16"-14 Grade 8  
Hex Head Nuts  
Qty 4



7/16"  
Flat Washers  
Qty 8



7/16"  
Lock Washer  
Qty 4

**Tools Required:**

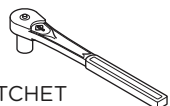

RATCHET



7/16"  
SOCKET



3/8"  
SOCKET

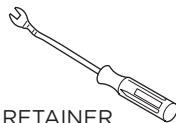

RETAINER  
REMOVAL TOOL

# FRONT STUBBY BUMPER

## FACTORY BUMPER REMOVAL

1. Disconnect negative battery terminal.
2. Underneath the front bumper is a plastic skid plate held on with 6 push pin tabs. Using a retainer removal tool, pry up the release on each pin and remove pins with skid plate.
3. Disconnect the wiring plug from the rear of each fog light if equipped.
4. Remove the 8 nuts holding the factory bumper to the frame. There are 4 nuts per side, once removed the bumper can be pulled straight forward and removed from the vehicle.
5. Remove the Plastic Panel on top of the Front Frame Rails by removing two (2) more Push Pin Tabs.
6. Remove the Vacuum Canister (if equipped) attached to the inside Driver Frame Rail by removing two (2) Factory Bolts holding it to the frame. The hoses do not need to be removed. The Vacuum Canister can be pushed out of the way enough to install the Magnum bumper.
7. If you want to reuse the factory Fog Lights, remove them from the Factory Bumper using a Philips head screw driver. Mount the Fog Lights in the Bumper using provided hardware.

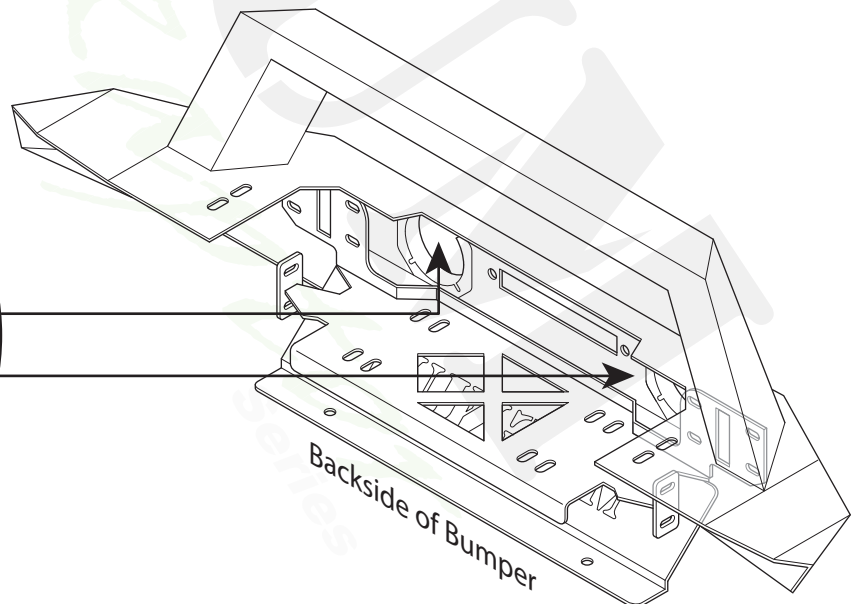
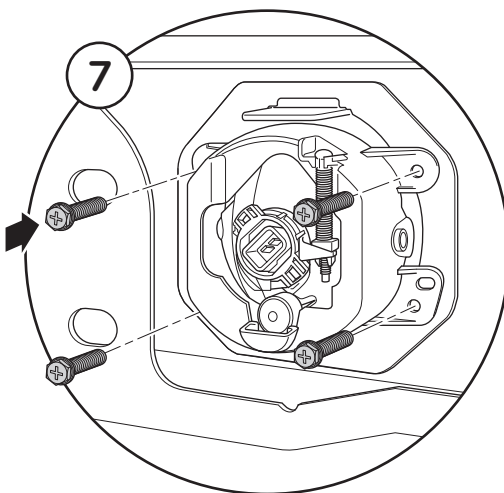
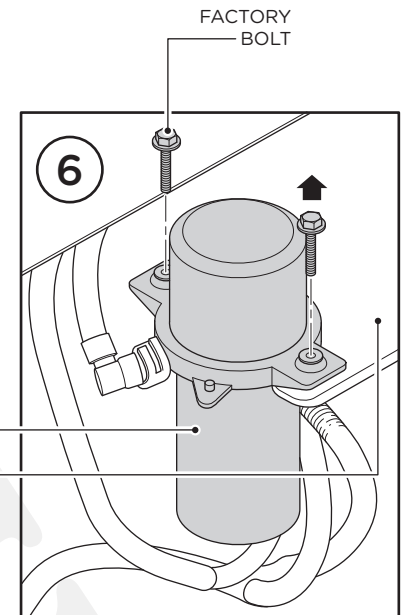
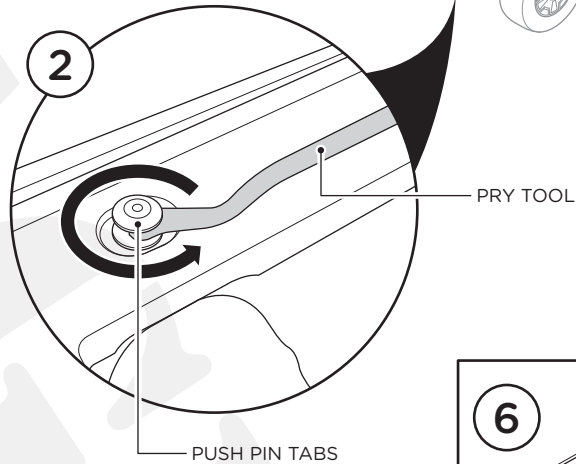
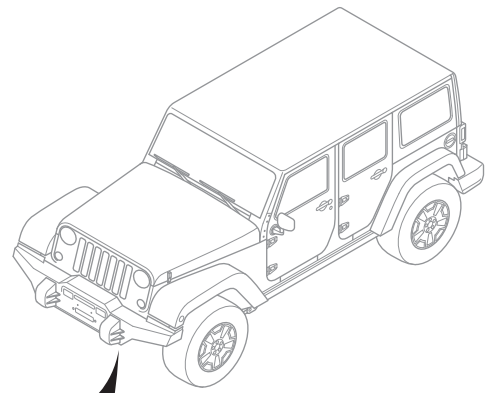



# FRONT STUBBY BUMPER

## BUMPER INSTALLATION

9. There are (4) nut plates to mount the bumper. The first set of nut plates are the (2) inside frame nut plates. Each nut plate must be slid up into the underside of the channel of the Jeep frame (9a). While holding the nut plate into place, secure the bracket of the bumper to the inside nut plate using two (2) 7/16" Grade 8 Flat Washers, two (2) 7/16"-14 x 1-1/2" Grade 8 Lock Washers and two (2) 7/16"-14 x 1-1/2" Grade 8 Hex Head Bolts (9b).

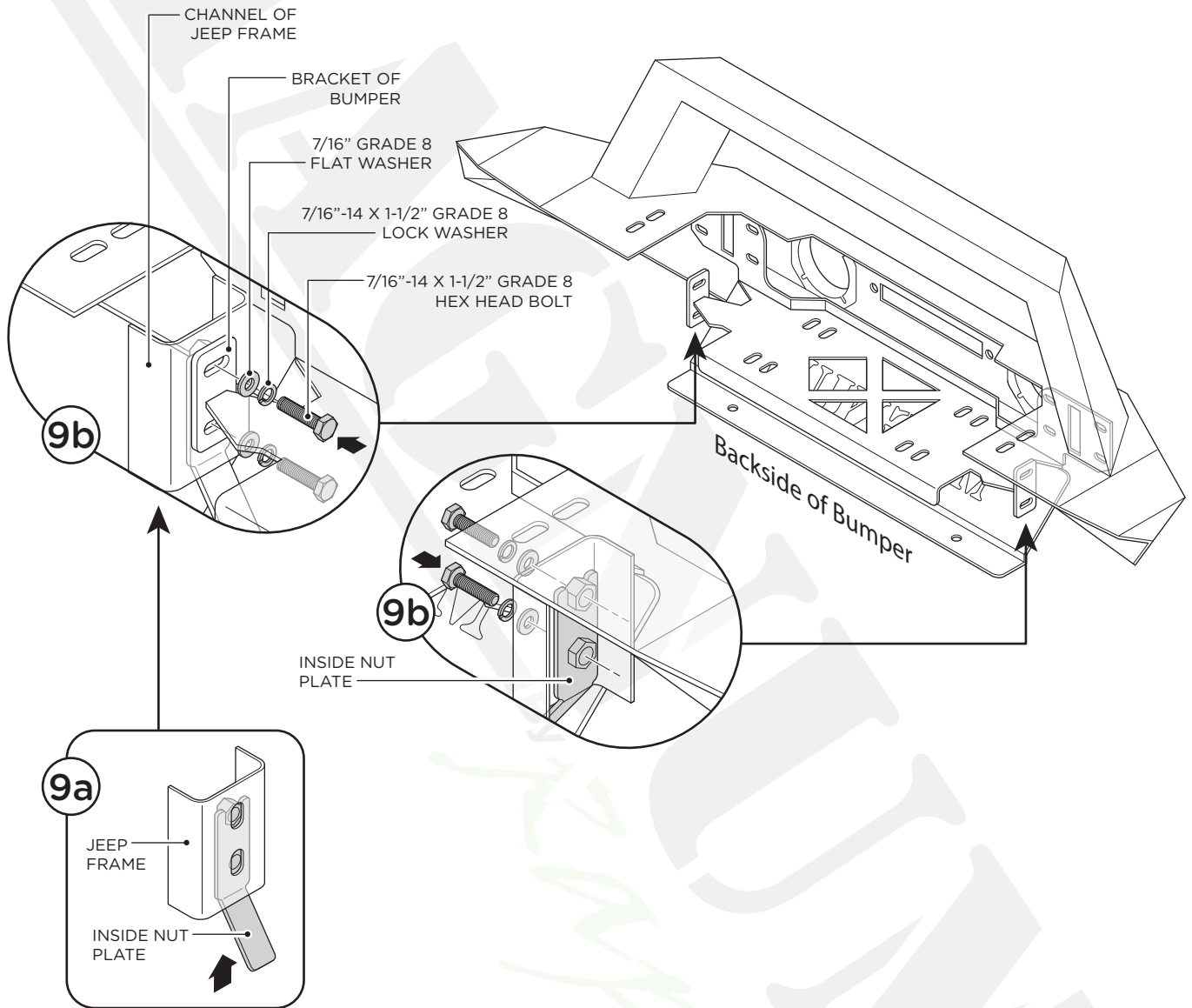

# FRONT STUBBY BUMPER

## BUMPER INSTALLATION

**10.** Reinstall Vacuum Canister with Factory Hardware.

**11.** If installing a Winch, proceed at this time. Depending on Winch, the Vacuum Canister may need to be relocated and its mounting bracket may need to be notched (relocation bracket is not included). A standard small chassis 8-10k Winch will fit without modifying or removing the Vacuum Canister.

**12.** Plug Fog Light Wiring Harness back into Fog Lights.

**13.** Install each Skid Plate using one (1) 7/16" Flat Washer, one (1) 7/16" Lock Washer and one (1) 7/16"-14 x 1.50" Button Head Bolt.

**NOTE:** 7/16" Nut Plate is placed into channel in frame of Jeep. Channel not shown in illustration for clarity.

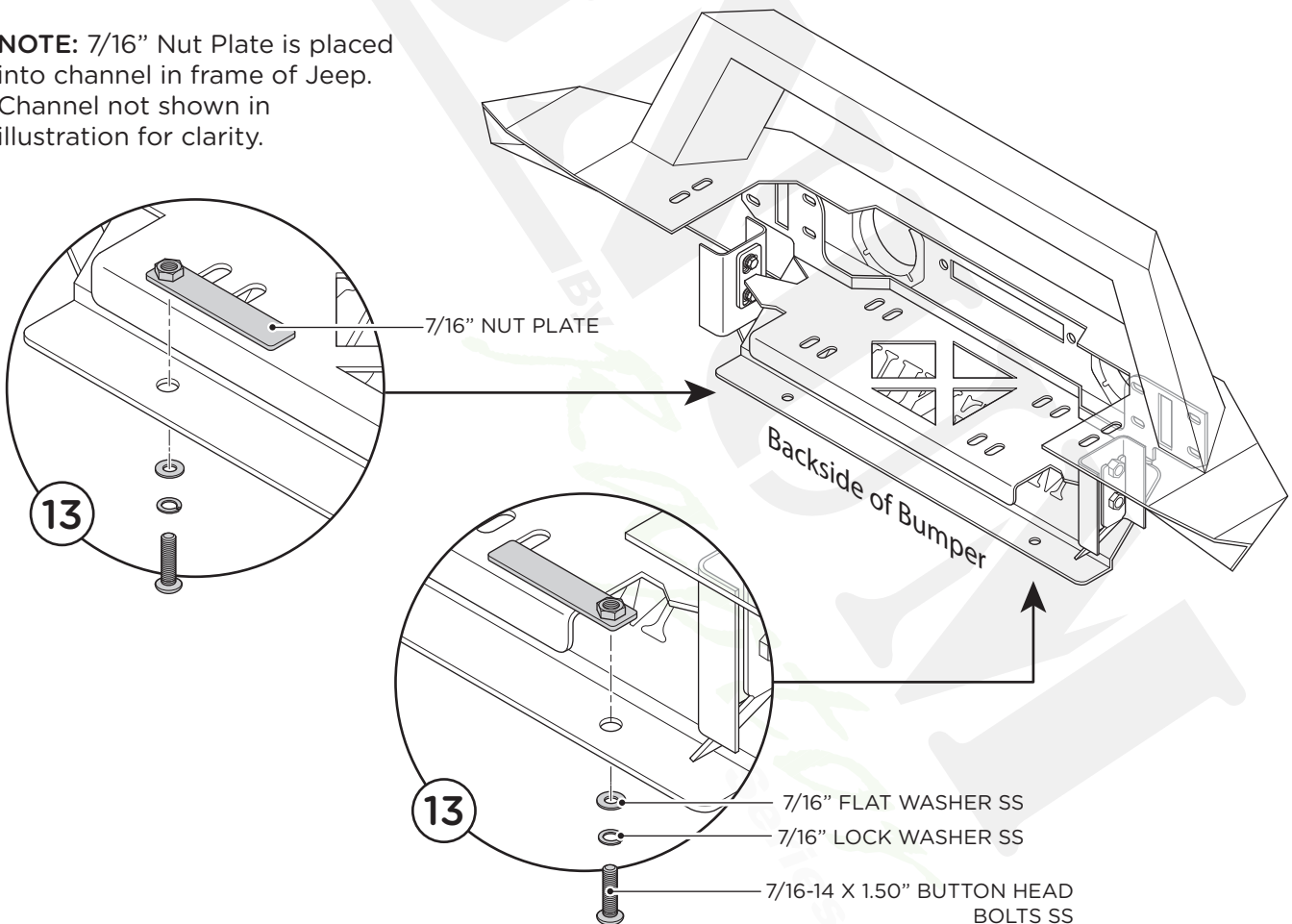
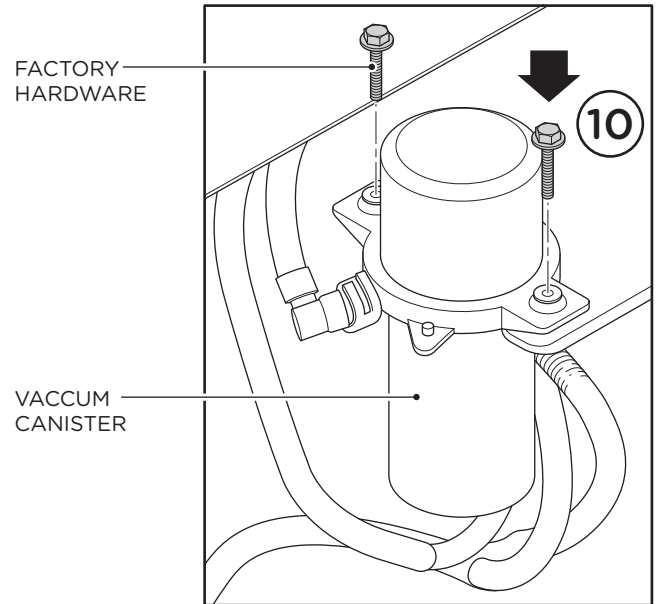



# FRONT STUBBY BUMPER

## BUMPER INSTALLATION

**14.** The Bumper includes mounts for a Hi-Lift type Jack (no jack or lights are included with the bumper). These mounts bolt to the holes in the top of the Bumper and sets the Jack above the Winch.

Install each Mount for Hi-Lift Jack to bumper using two (2) 7/16"-14 x 1-1/2" Grade 8 Hex Head Bolts, two (2) 7/16" Grade 8 Flat Washers, two (2) 7/16"-14 x 1-1/2" Grade 8 Lock Washers and two (2) 7/16"-14 Grade 8 Hex Head Nuts.

It may be necessary to remove Hi-Lift Base from jack.

**15.** Install Hi-Lift jack using two (2) 7/16" Grade 8 Flat Washers, two (2) 7/16"-14 x 1-1/2" Grade 8 Lock Washers and two (2) 7/16"-14 x 1-1/2" Grade 8 Hex Head Bolts and two (2) 7/16" Grade 8 Hex Head Nuts (1b).

**17.** Reconnect battery ground.

